

### METAL PANEL APPLICATIONS

#### STEP 1: Install Vertical Support Columns

**Note:** Install vertical support columns to girt framing. (Girt spacing max 6'0")

**1.a** – Determine desired height of canopy above building girt. Align short edge of canopy with the corner of the building. Drill 1 1/16" holes through pre-drilled canopy angle holes. (These holes are aligned with the center of the zee rafter holes used for the pipe hangers at the wall attachment angle of the canopy.)

**1.b** – Align centerline of support columns with 1 1/16" holes drilled in step 1.a centerline of zee rafters on canopy between girts. Make sure support columns are perpendicular to top and bottom girt. Attach mounting clips to each end of telescoping support columns with (4) #12 SDS per clip. Slide adjust columns to proper length in order to fit between girts (6' maximum). Mark hole locations for mounting clip on bottom girt. Install mounting clip brace to bottom girt with (4) #12 SDS per brace. Place mounting clip over installed brace and secure columns to girts with (4) #12 SDS per clip. Install (2) #12 SDS in the web and (1) in each flange at top and bottom of overlap in channels.

#### STEP 2: Install Lower Support Bolts

**2.a** – Match drill through previously drilled holes in wall panel through centerline of support columns.

**2.b** – With canopy repositioned and matching holes in canopy and wall panel aligned, attach canopy to wall panel and support column using 5/8" x 7" bolt with washer. (If hole penetrates the high rib of the panel, use PVC spacer and washer between wall panel and support column.) **Note:** Before tightening bolts, apply sealant at penetration points.

#### STEP 3: Attach Pipe Hangers to Canopy

**3.a** – Thread 5/8" nut on the short rod end, slide on 5/8" washer and insert into hole on top of the two outside canopy rafters to lowest point. Secure with 5/8" nuts and washers on underside of rafter. (Typical for each pipe hanger.)

#### STEP 4: Attach Pipe Hangers to Wall

**4.a** – Locate the elevation at the point where the long rod end and pipe hanger assembly will penetrate the wall. (Longer pipe hanger will attach at mitered corner of canopy to short rafter and angle back to corner of building.) Drill 1 1/16" hole through panel and support columns. Thread 5/8" nut on long rod end and slide on 5/8" washer. Insert long rod through wall panel, 5/8" washer and support columns. Secure at support column with 5/8" nuts and washers.

**Note:** Before tightening bolts, apply sealant at penetration points.

#### STEP 5: Repeat Steps 1 – 4 on Other Corner Canopy

#### STEP 6: Install Bracing on Vertical Support Columns

**6.a** – Place cee member directly above the long rod end connection on the vertical support column. Install onto vertical support columns with (2) #12 SDS each end.

**6.b** – Place x-bracing across vertical support columns with the bottom of the x-brace directly above the lower support bolt and the top directly underneath the long rod end connection. Install onto vertical support columns with (3) #12 SDS each end.

**6.c** – Install (1) #12 SDS into lap of x-bracing.

#### STEP 7: Adjust Pitch of Canopy

**7.a** – Adjust pipe hanger yoke ends so the canopy slopes back toward wall 1/2" to 1" (for rear-mounted drains).

#### Metal Wall Install:

(One hardware kit per hanger)

- (1) Pipe Hanger
- (1) 3-1/2" x 5/8" Rod End
- (1) 10" x 5/8" Rod End
- (1) 2pc Telescoping Channel
- (2) 12ga Channel Clips
- (1) 12ga Channel Clip Brace
- (28) #12 x 3/4" SDS Screws
- (1) 7" x 5/8" Hex Bolt
- (5) 5/8" Nuts
- (8) 5/8" Washers
- (2) PVC Spacers

#### Brace Install:

- (One set per side)
- (2) X-Braces
- (1) Cee Member
- (17) #12 x 3/4" SDS Screws

### METAL PANEL APPLICATIONS (cont'd)

#### CORNER CANOPY CHANNEL INSTALL

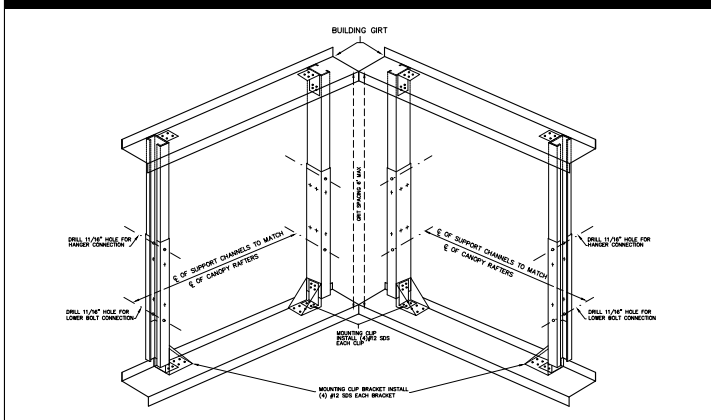

#### CORNER CANOPY BRACE INSTALL

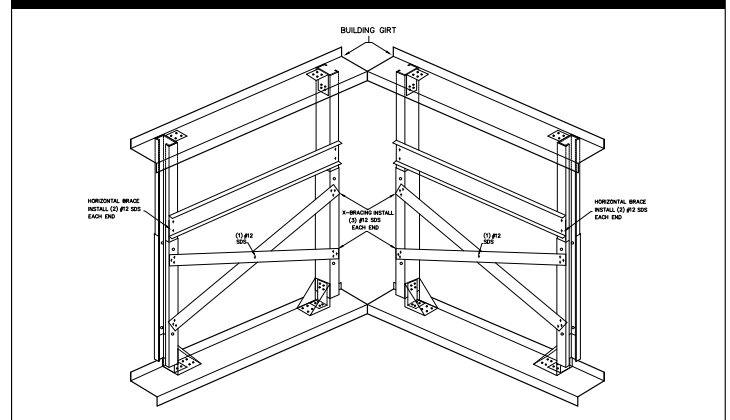

#### CORNER CANOPY METAL INSTALL (WITH CANOPY)

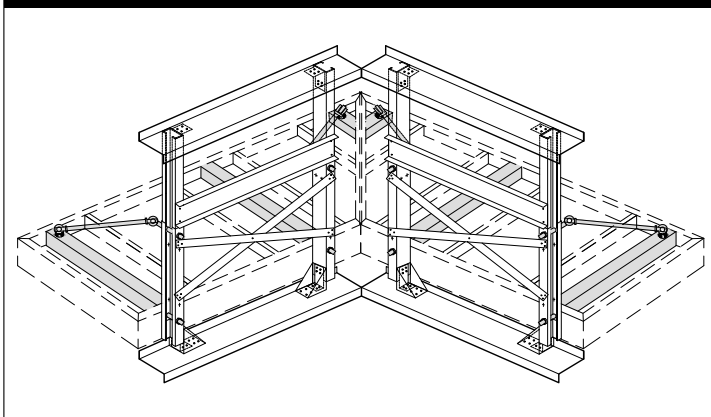

#### CORNER CANOPY SPLICE INSTRUCTION

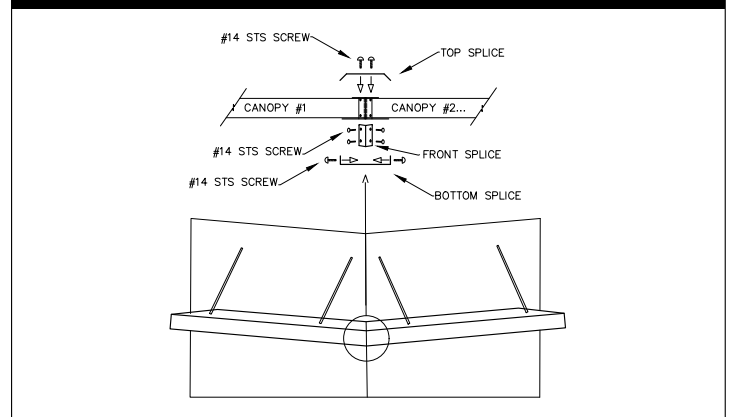

### MASONRY APPLICATIONS

#### STEP 1: Install Lower Support Bolts

**1.a** – Determine desired height of canopy and align short edge of canopy with the corner of the building. Mark well at locations where pre-attached canopy rafter angle holes meet wall.

**1.b** – Drill holes in masonry and install wall anchors sized to accept 5/8" bolts and appropriate design for masonry type.

**Note:** Wall anchors by others.

**1.c** – Insert 5/8" x 3" bolt with washer through canopy angle and into wall anchor.

#### STEP 2: Attach Pipe Hangers to Canopy

**2.a** – Thread 5/8" nut on one end of the pipe hanger rod end, slide on 5/8" washer and insert into hole on top of the rafter to lowest point.

**2.b** – Secure with 5/8" nuts and washers on underside of rafter.

#### STEP 3: Attach Pipe Hangers to Wall

**3.a** – Locate elevation at the point where opposite rod end will penetrate the wall. (Longer pipe hanger will attach at mitered corner of canopy to short rafter and angle back to corner of building.)

**3.b** – Drill holes in masonry and install wall anchors sized to accept 5/8" bolts and appropriate design for masonry. **Note:** Wall anchors by others.

**3.c** – Insert 5/8" x 3.5" threaded rod end into wall anchor.

**3.d** – Attach rod end to pipe hanger with clevis pin.

#### STEP 4: Repeat Steps 1 – 3 on Other Corner Canopy

#### STEP 5: Adjust Pitch of Canopy

**5.a** – Adjust pipe hanger yoke ends so the canopy slopes back toward wall 1/2" to 1" (for rear-mounted drains).

#### Metal Wall Install:

(One hardware kit per hanger)

- (1) Pipe hanger
- (2) 3-1/2" x 5/8" Rod Ends
- (1) 3" x 5/8" Hex Bolt
- (4) 5/8" Nuts
- (4) 5/8" Washers

