

STANDARD ARCHITECTURAL & CUSTOM TRIM AND FLASHING

Find the perfect fit with Metallic Products standard building trim and die formed flashing.

STANDARD FEATURES

- Available in running lengths up to 21'
- Constructed of 26-gauge material
- Available in Galvalume, Polar White or standard color
- Boxed for shipment

STANDARD TRIM ITEMS

- Box Gutter
- Sculptured Gutter
- Box Rake Trim
- Sculptured Rake Trim
- Peak Boxes
- Corner Boxes
- Downspout (straight)
- Downspout (with kickout)
- Downspout Outlet
- Downspout Elbow
- Downspout Offset
- Sculptured Eave Trim
- High Side Eave Trim
- Simple Eave Trim
- Corner Trim "R" Panel
- Corner Trim "U" Panel
- Inside Corner "R" Panel
- Inside Corner "U" Panel
- Jamb Trim
- Head Trim
- Sill Trim
- Drip Trim
- Cap Trim
- Starter Trim "A" Panel
- Transition Trim
- Ridge Cap
- Soffit / Valley Flashing
- Valley Flashing



TRIM PROFILES

BOX GUTTER – EGI

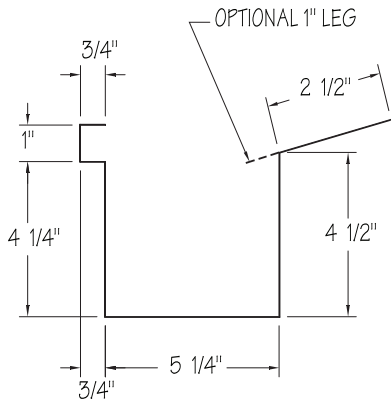

BOX RAKE TRIM – RT1

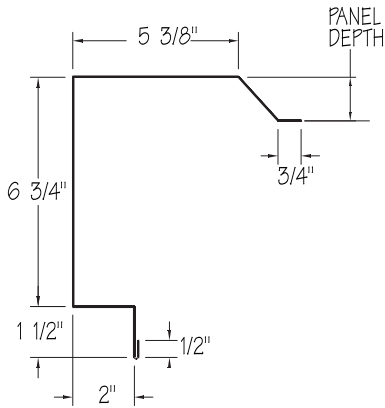

JAMB TRIM – JT17

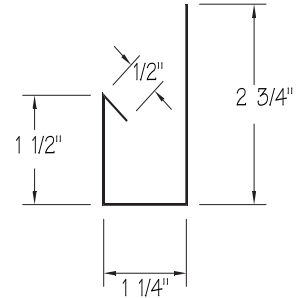

SCULPTURED GUTTER – EG2

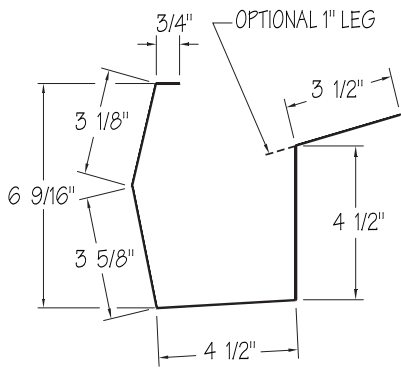

SCULPTURED RAKE TRIM – RT2

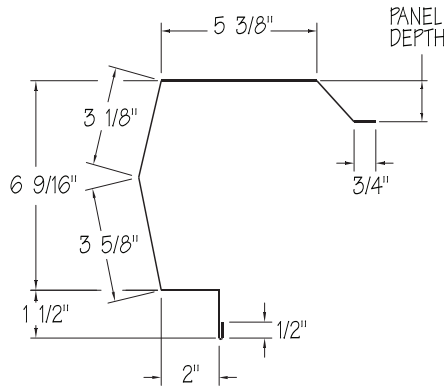

HEAD TRIM – HT18

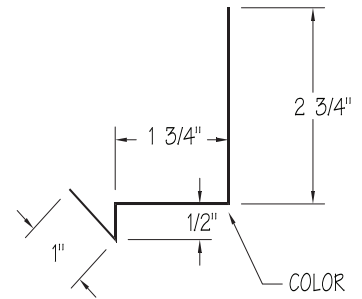

DRIP TRIM – DT21

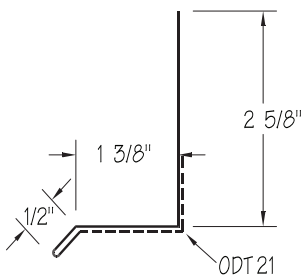

SILL TRIM – ST20

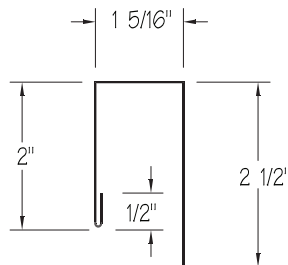

HEAD TRIM – HT19

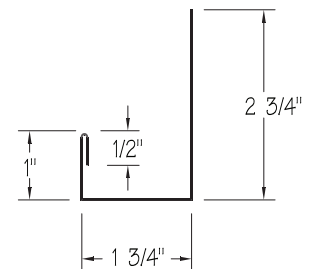

TRIM PROFILES

SCULPTURED EAVE TRIM – ET3

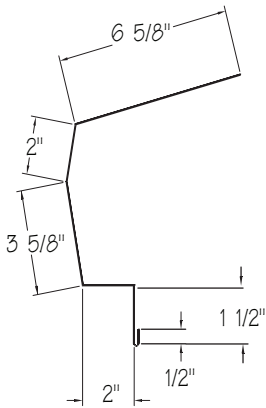

HIGH SIDE EAVE TRIM – ET4

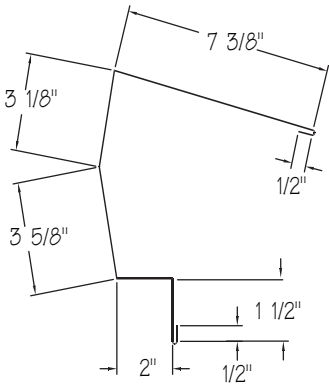

SIMPLE EAVE TRIM – ET5

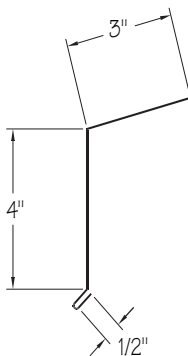

CORNER TRIM "R" PANEL – CT6

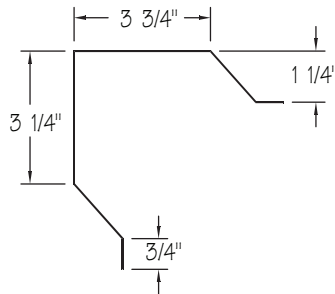

CORNER TRIM "U" PANEL – CT7

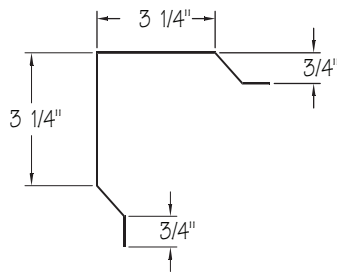

INSIDE CORNER "R" PANEL – CT8

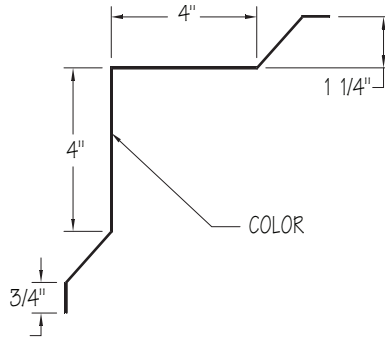

STARTER TRIM "A" PANEL – ST26

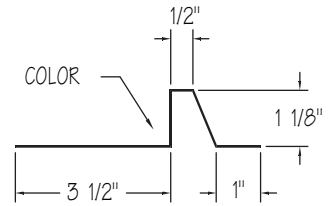

TRANSITION TRIM – TT27

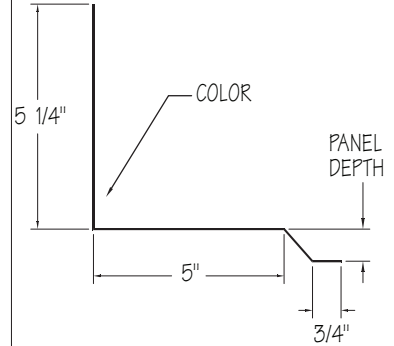

INSIDE CORNER "U" PANEL – CT9

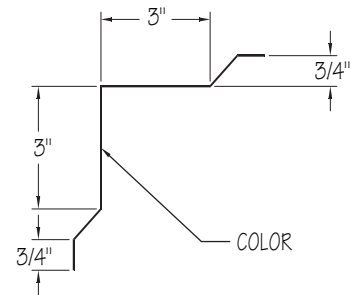

TRIM PROFILES

PEAK BOXES

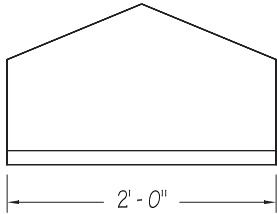

CORNER BOXES

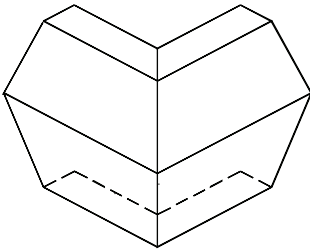

DOWNSPOUT (STRAIGHT) – DS12

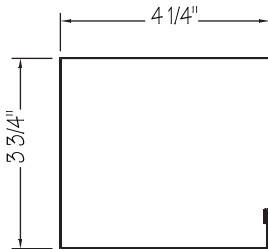

DOWNSPOUT (WITH KICKOUT) – DS13



DOWNSPOUT OUTLET – DS14

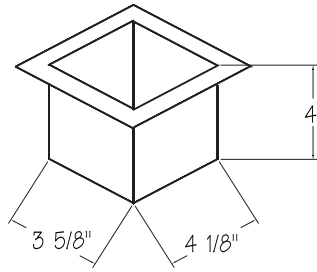

DOWNSPOUT ELBOW 45° – DS15

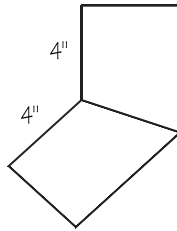

DOWNSPOUT OFFSET – DS16

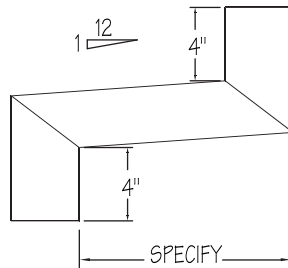

SOFFIT/VALLEY FLASHING – SV24

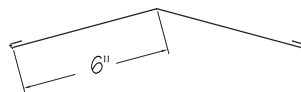

RIDGE CAP – RC22

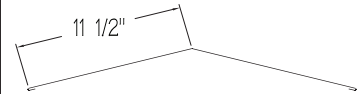

RIDGE CAP – RC23

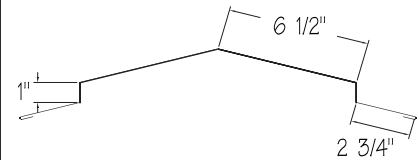

VALLEY FLASHING – SV25



CAP TRIM – CT26

